

Ground Floor

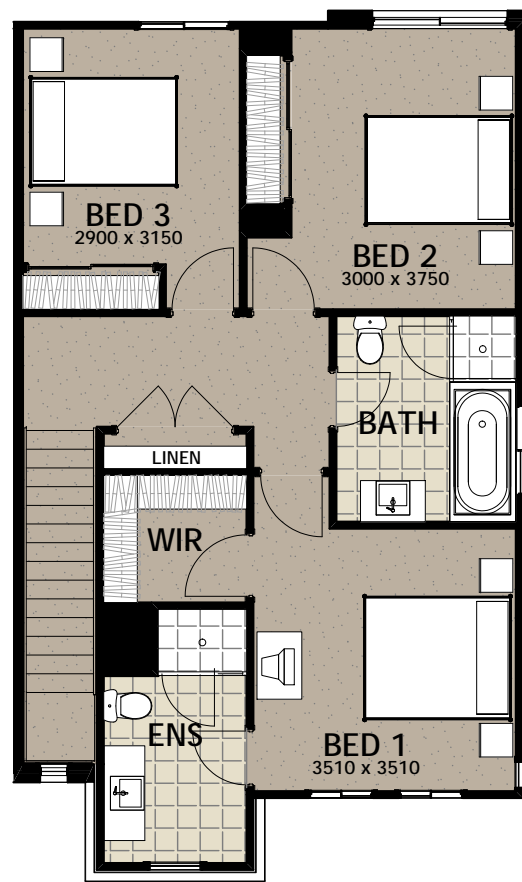

First Floor

Venice

4233

Cobden Parkes Crescent

| | |
|------------------------------|---------|
| Type : | 3 Bed |
| Internal Area Ground Floor : | 63 sqm |
| Internal Area First Floor : | 74 sqm |
| Porch : | 2 sqm |
| Garage : | 24 sqm |
| Total Area : | 163 sqm |



Streetscape

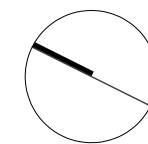

Please note that the above floor plan is an artist's impression only and is not to scale. Whilst every care is taken to ensure that this plan is correct, all room sizes and areas are approximate only and may vary. Final design may alter for reasons outside of our control and may change during the development process. Dimensions, specifications and fittings may be changed without notice. Image shown above is indicative only and is for illustrative purposes only. Purchasers must rely on their own enquiries and the Contract for Sale.